

BLACKBAR

-BATTERY- | Pre-filled battery

USER INFORMATION

Please read this leaflet carefully through. It contains important information on safe use and storage, as well as possible adverse effects and hazards. E-cigarette (Pre-filled battery).

Not refillable!

Composition: PBCA circuit board, magnet, electrode, battery core, plastic casing. Replaceable battery compartment for e-cigarettes. Manufacturing batch and, if applicable, best before date: see imprint on the folding box.

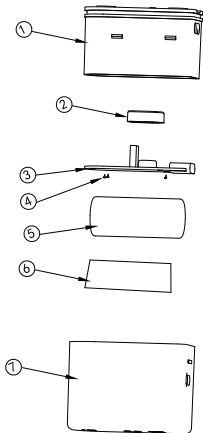

- 1: PC-2805 shell
- 2: Food grade silicone
- 3: PBCA circuit board
- 4: 3* Fixing screws
- 5: Batteries
- 6: Battery core protection cotton
- 7: PC-2805 shell

INFORMATION ABOUT GROUPS OF PEOPLE WHO SHOULD NOT USE THE PRODUCT:

The following groups of people should not use nicotine-free and/or flavored e-liquids: non-smokers, people with known hypersensitivity or allergy to any of the specified ingredients, children, minors under 18, pregnant women, breastfeeding women, people with known diseases of the vascular system, and people who have been treated by a doctor for other reasons. Consumption of e-liquids is prohibited by said groups of people. If you are unsure whether it is safe for you to consume this product, please consult your doctor before using it for the first time.

SAFE STORAGE/STORAGE INFORMATION

Keep the product cool, dry, and out of the reach of children. If the product falls apart due to a drop, Please dispose of damaged products immediately at appropriate collection points for household chemicals. Do NOT store this product with food or beverages.

if the e-cigarette were dropped, the consumer shall be informed that the following must be checked:

- that the elements have not become loose;
- that there is no leakage of e-liquid;
- that the mouthpiece is not damaged;
- if a visual examination of the product shows no signs of damage, the user may use the equipment after cleaning it and in particular the mouthpiece, using paper or a dry cloth;
- the electronic cigarette shall not be used if parts are cracked or deformed and the defective items shall be replaced;
- the electronic cigarette shall not be used when its tank is empty or almost empty as well as if the user notices a perceptible change in flavour;

Instructions for cleaning your e-cigarette:

When you use them, they mix with dirt, grime, and bacteria. To clean your e-cigarette, you'll need to use a new paper towel and cotton swabs on a clean area to wipe down the parts.

SAFE USE INFORMATION

This product is a e-cigarette (Pre-filled battery), Cannot refill e-liquid, rechargeable, Be sure to read all warnings and usage instructions on the device before use packaging and in this leaflet. The use of technically defective devices can pose risks to your health (see below). Use the product only according to the instructions for use and try not to open it even after it is completely used up. If the liquid from the device comes into contact with your skin, promptly wash it thoroughly with warm water and soap. If you have swallowed liquid, contact a doctor immediately. Hold the original packaging ready.

Store the product in a dry place and NOT at temperatures below 0°C or above 40°C.

It is recommended not to smoke e-cigarettes for more than 20 seconds to prevent overheating

If you encounter any signs of an allergic reaction during or after product use, such as a rash, nausea, dizziness, shortness of breath, or similar symptoms, discontinue use immediately and seek medical advice. Please present this leaflet along with the product packaging when consulting a doctor. This product is NOT intended for use by children or adolescents under 18 years of age.

! INFORMATION FOR SAFE REFILLING
This product cannot and must NOT be refilled!

DAUGHTER/ADVERSE EFFECTS INFORMATION:

CAUTION: Nicotine is a highly addictive and toxic substance. Nicotine causes physical and psychological dependence. Nicotine can trigger vascular diseases, worsen existing vascular diseases, or have a detrimental effect on diabetes. Nicotine can be transmitted to an infant through breast milk in breastfeeding women. The use of e-liquids containing nicotine can generally have negative effects on blood vessels and blood circulation. When using E-liquids with or without nicotine in defective or malfunctioning e-cigarettes can lead to the development of further toxic substances or substances that are highly harmful to health (e.g., formaldehyde, acetaldehyde, etc.). If uncertain about the device's proper functioning, refrain from its use.

ORGANIZING INSTRUCTIONS:



← Pre-filled pod

← Pre-filled battery

The pre-filled pod and pre-filled battery are combined up and down, and can be used by connecting the positive and negative electrodes at both ends. When the battery is out of power, the pre-filled battery will flash a red light to alarm. When the battery is fully charged, the pre-filled battery RGB light will light up white.

BLACKBAR -BATTERY- | Pre-filled battery

CUSTOMER FEEDBACK

Name	Contact Number
Method Purchase	Date
Consumer issues :	
Adverse event reporting:	
Feedback:	

If you have any after-sales quality problems, Please contact your local dealer.



(5)310-555-10
0919 077 0677

! Attention

Please replace the cartridge when running out of e-liquid.

Please properly install the cartridge before use.

Do not disassemble the cartridge. The company won't be responsible for any product damage or personal injury caused by the improper operation.

INFORMATION FOR PRIVATE HOUSEHOLDS

Manufacturer information in accordance with Section 18 Paragraph 4 ElektroG (new)

The Electrical and Electronic Equipment Act (ElektroG) contains a number of requirements for the handling of electrical and electronic devices. The most significant ones are summarized herein.

1. Separate collection of old devices

Electrical and electronic equipment categorized as waste is commonly termed as old equipment. Owners of such outdated devices are obligated to segregate these items from general municipal waste. Specifically, these old devices should not be disposed of in household waste; instead, they should be deposited within designated collection and return systems.

2. Batteries and accumulators as well as lamps

Owners of old devices have old batteries and accumulators that are not enclosed by the old device, as well as lamps, which can be removed from the old device non-destructively, usually before handing it over to a collection point separate old device. This does not apply if old devices are prepared for reuse with the involvement of a public waste disposal agency.

3. Options for returning old devices

Owners of old devices from private households can deliver them free of charge at public waste disposal collection points or at designated collection points arranged by manufacturers or distributors in accordance with the ElektroG. Stores with a sales area of at least 400 m² for electrical and electronic devices are obliged to accept returns, as well as grocery stores with a total sales area of at least 800 m². These stores must either operate permanently or open several times a year, offering electrical and electronic devices for sale.

This obligation extends to sales conducted through remote communication means, provided the storage and shipping areas for these devices are at least 400 m², or the total storage and shipping areas are at least 800 m². Distributors must ensure accessible return options within a reasonable distance from the end user. The option of returning an old device free of charge is available if a distributor is obligated to take it back, especially when delivering a new device that essentially performs the same functions.

In cases where a new device is delivered to a private household, the old device of the same type can also be handed over there for free collection. This policy applies specifically to remote sales of devices falling under Categories 1, 2, or 4 in accordance with Section 2 Paragraph 1 of the ElektroG, namely "heat exchangers," "screen devices," or "large appliances" (the latter having at least one external dimension over 50 centimeters).

End users must be informed of suitable return options at the time of purchase. Additionally, there is an option for free return to distributor collection points, irrespective of purchasing a new device, for old devices not exceeding 25 centimeters in any external dimension. This return option is limited to three old devices per type of device.

4. Meaning of the "crossed-out trash can" symbol

The symbol of a crossed-out garbage can, which is regularly shown on electrical and electronic devices points out that the respective device must be collected separately from unsorted municipal waste at the end of its service life.

The following battery or accumulator is included in this electrical device
Battery type: 13350 500 mAh 3.7V Chemical system: Lithium-ion (Li-ion)



Battery type: 13350 500 mAh 3.7V Chemical system: Lithium-ion (Li-ion)

Information for private households:

Batteries must not be discarded in household waste. Used batteries require proper disposal. To facilitate this, suitable containers for battery disposal are accessible at outlets distributing batteries and at municipal collection points. When disposing of packaging, adherence to pertinent environmental regulations is advised.

Information about the dealer:

IMPORTER: SHFT ELECTRONIC GADGETS TRADING OPC

Assessment No: A9 (I) 12 -23 -03342

Address: 1201 Metropolitan Tower A. Mabini St., Barangay 699 First District

1004 Malate NCR, City of Manila, First District Philippines

E-mail: shftcorporation@gmail.com

Website: www.shft.ph

ROHS

Batch No.240805

Best By:2025-08-04

Manufactured Date:2024-08-05

